

# Option I WiFi Configuration

Via App  
(Smart Phone/Pad)

## Preparation

- 1.1 Power WiFi inverter (or EzLogger WiFi) on.
- 1.2 If you are configuring WiFi inverter, make sure the yellow led on front cover is flickering. Otherwise please set the communication to WiFi according to user manual of inverter at first.
- 1.3 Power WiFi router on.
- 1.4 Download 'SolarMan Tool' app from google play or apple app store and install it on smart phone or pad. Run it.

Note:  
After configuration, please register on portal and create your own PV station

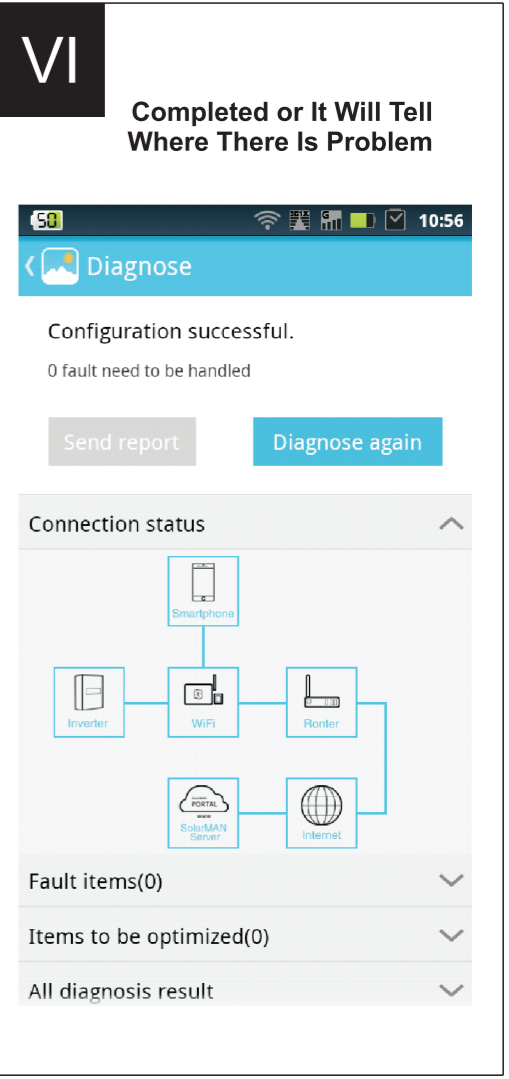
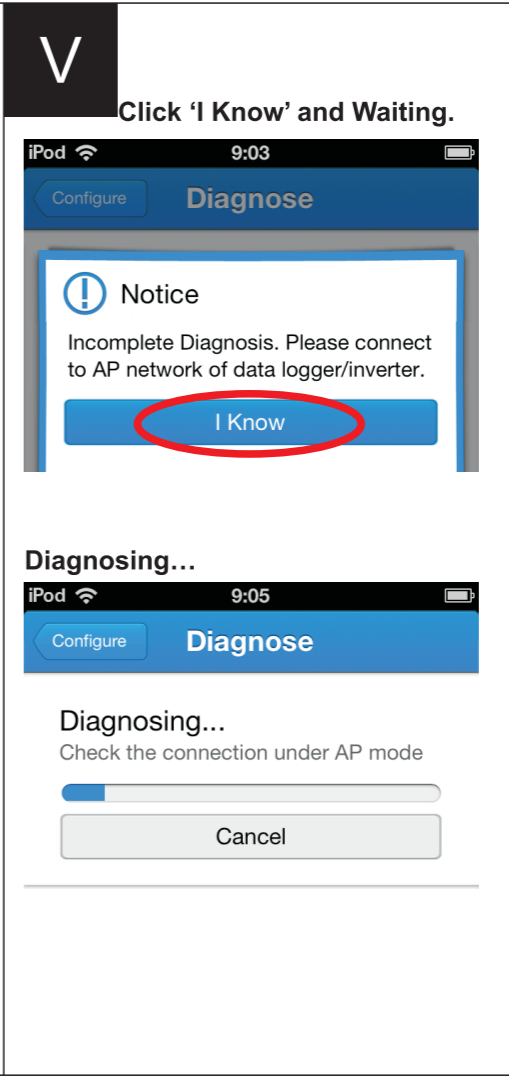
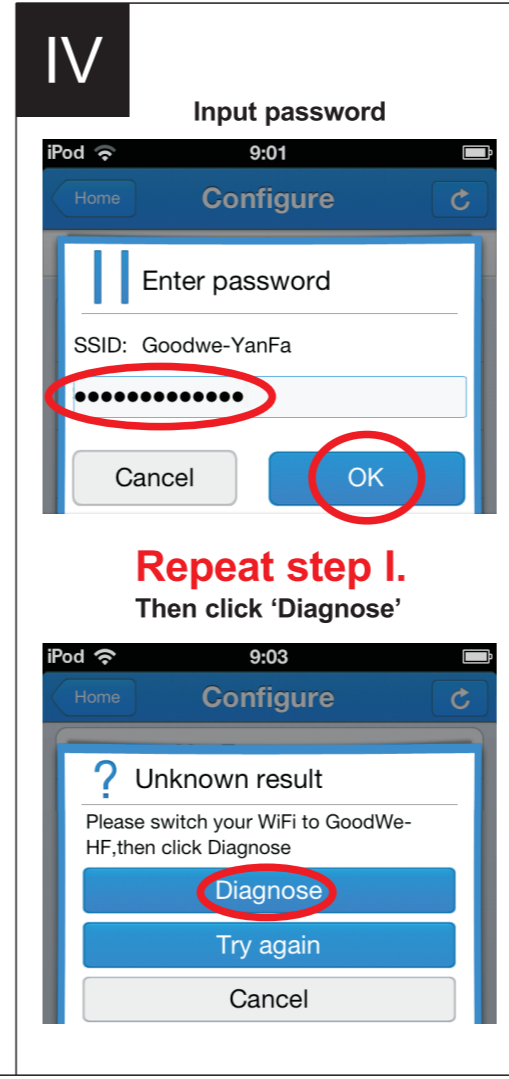
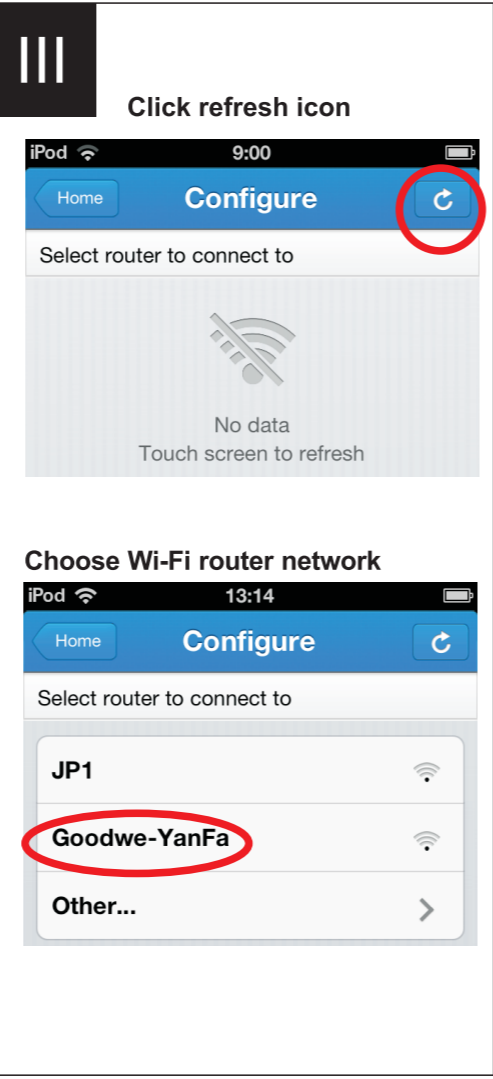
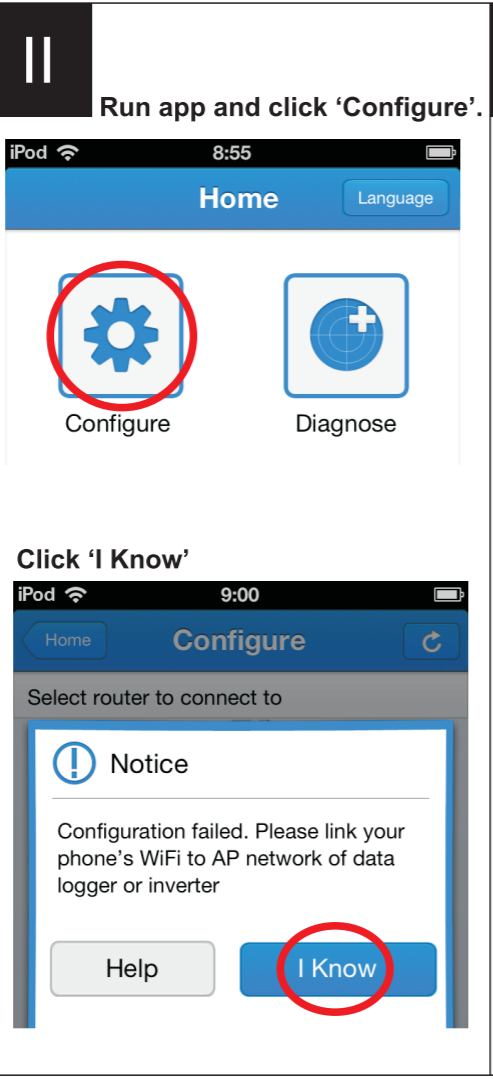
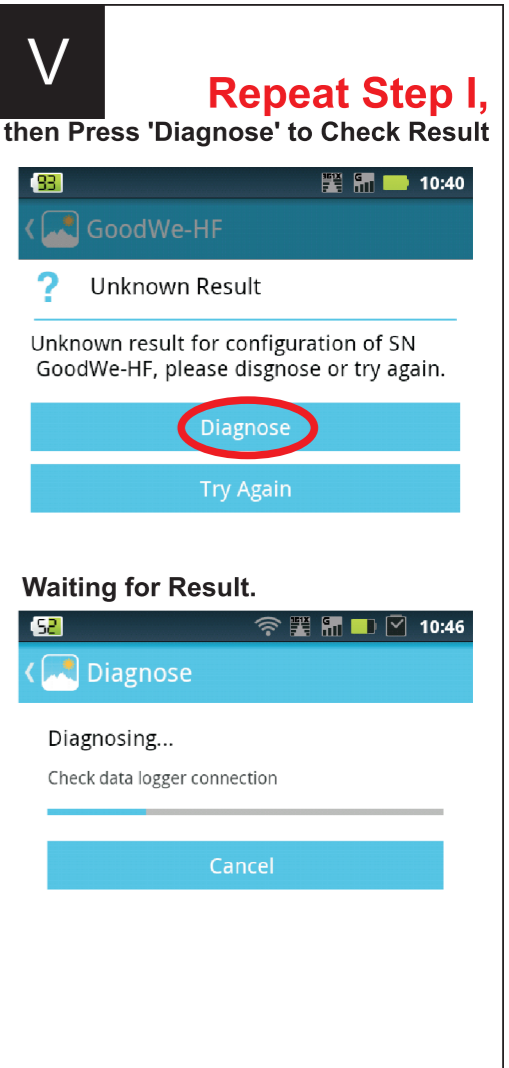
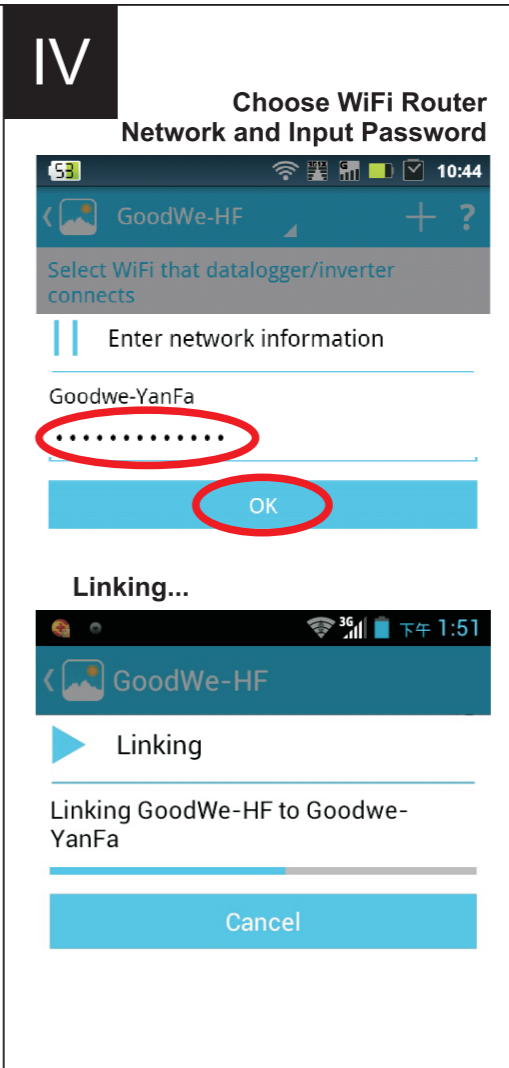
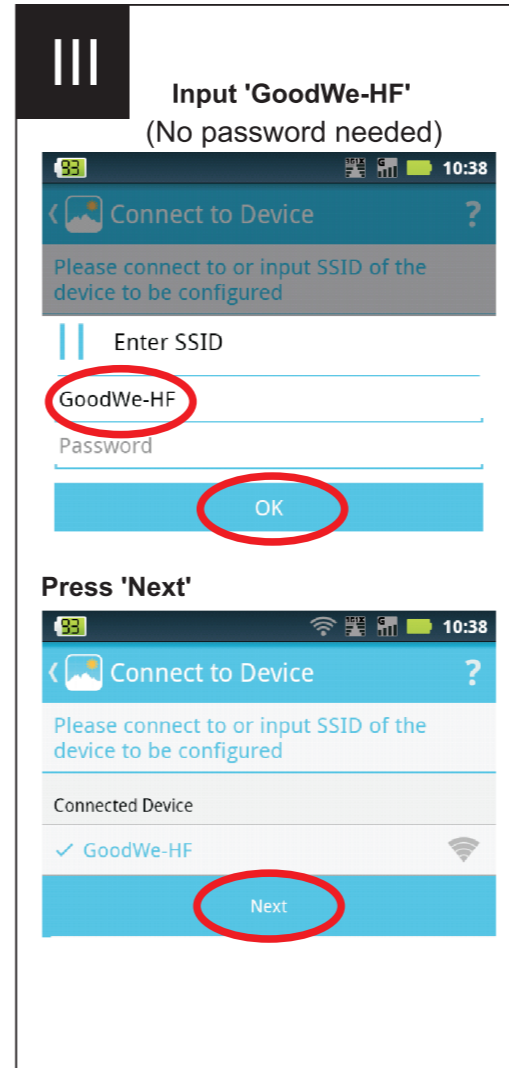
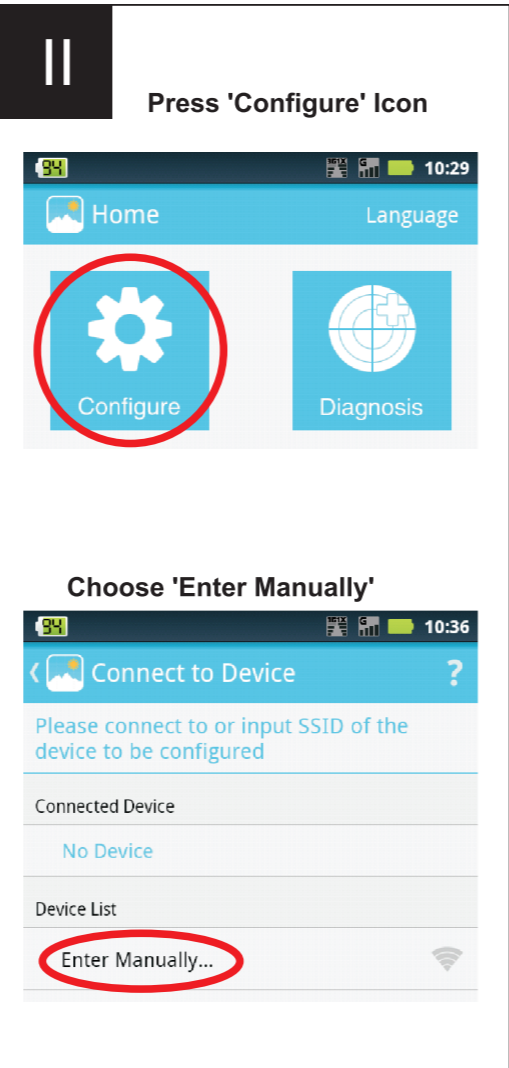
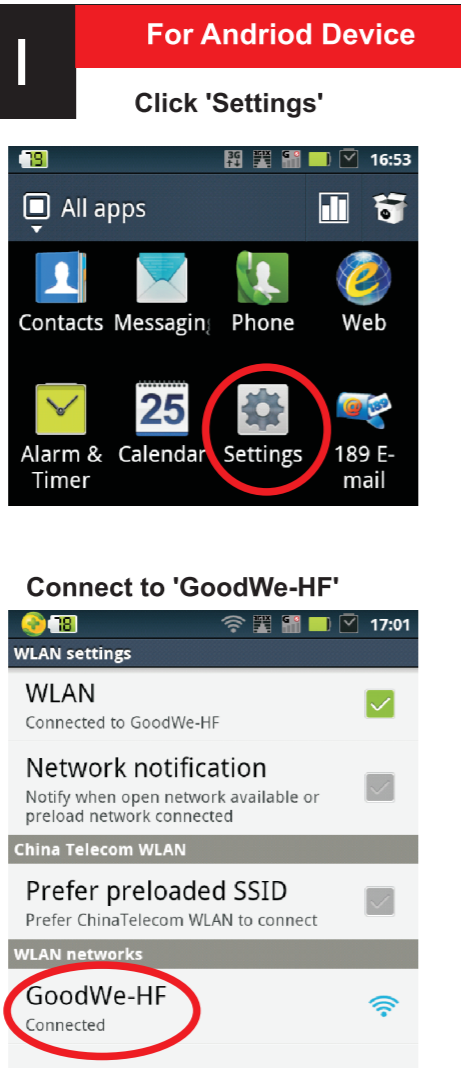

## Option II

# WiFi Configuration

Via Laptop

### I 1. Preparation

- 1.1 Power WiFi inverter (or EzLogger WiFi) on.
- 1.2 If you are configuring WiFi inverter, make sure the yellow led on front cover is flickering. Otherwise please set the communication to WiFi according to user manual of inverter at first.
- 1.3 Power WiFi router on.
- 1.4 Switch on the WiFi of laptop.

### II 2. Connect WiFi to 'GoodWe-HF'

- 2.1 Search WiFi network and connect "GoodWe-HF".
- 2.2 Browse website: <http://10.10.100.254>

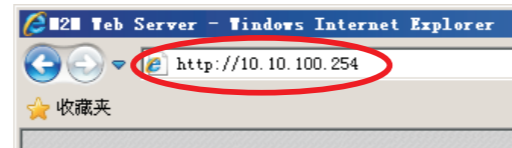

- 2.3 Enter User name:"admin",Password:"admin"



### V 3.3 Change Password

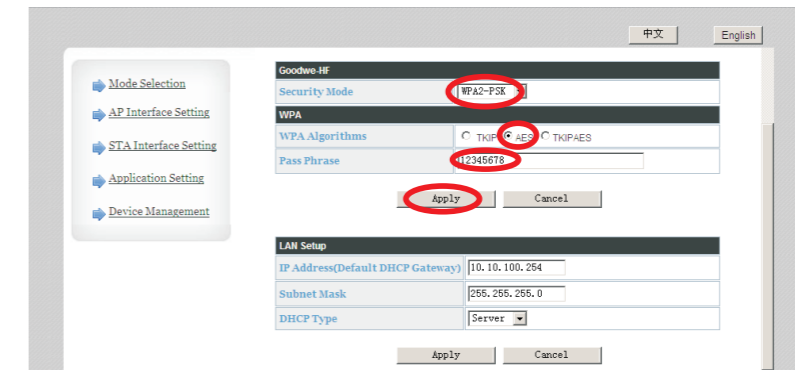

### VI 4. Choose WiFi signal of your own router by "STA Interface Setting"

- 4.1 Click 'Search' button and choose your own WiFi connection point

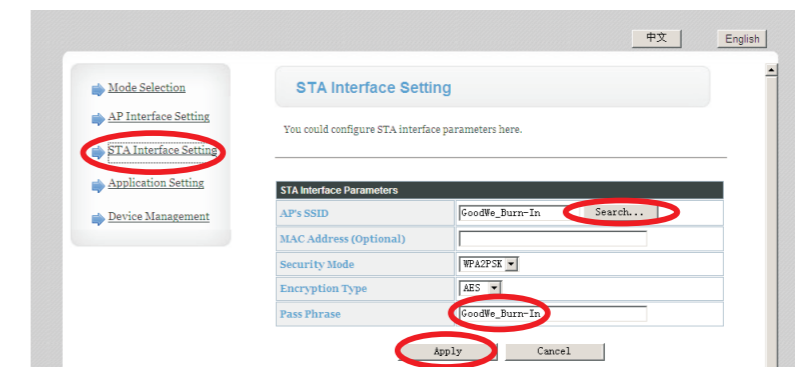

### III 3. Configure security setting by "AP Interface Setting"

### 3.1 Change Network name

- 3.1 Change Network name

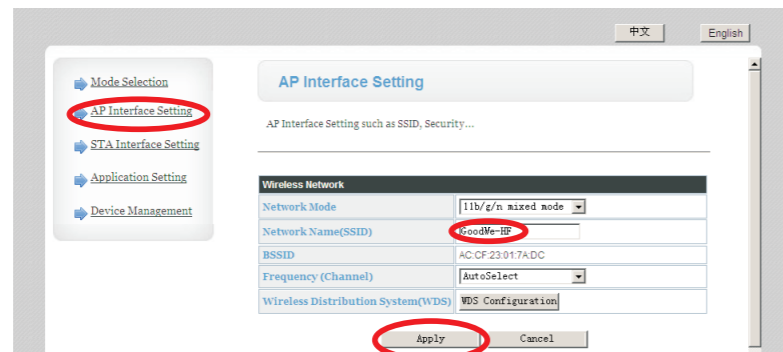

### IV 3.2 Change Security Mode

- 3.2 Change Security Mode

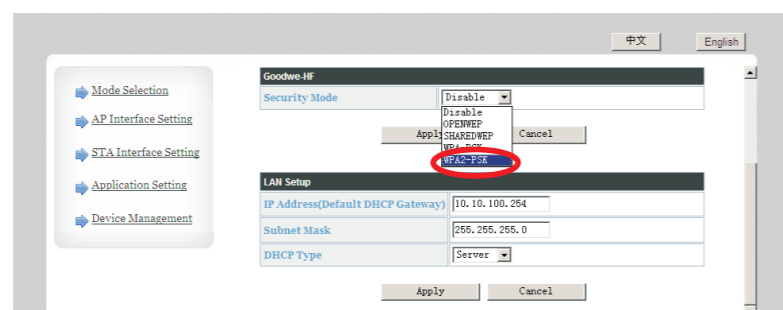

### VII 5. Restart WiFi module by "Device Management"

### 5. Restart WiFi module

- 5.1 Restart WiFi module

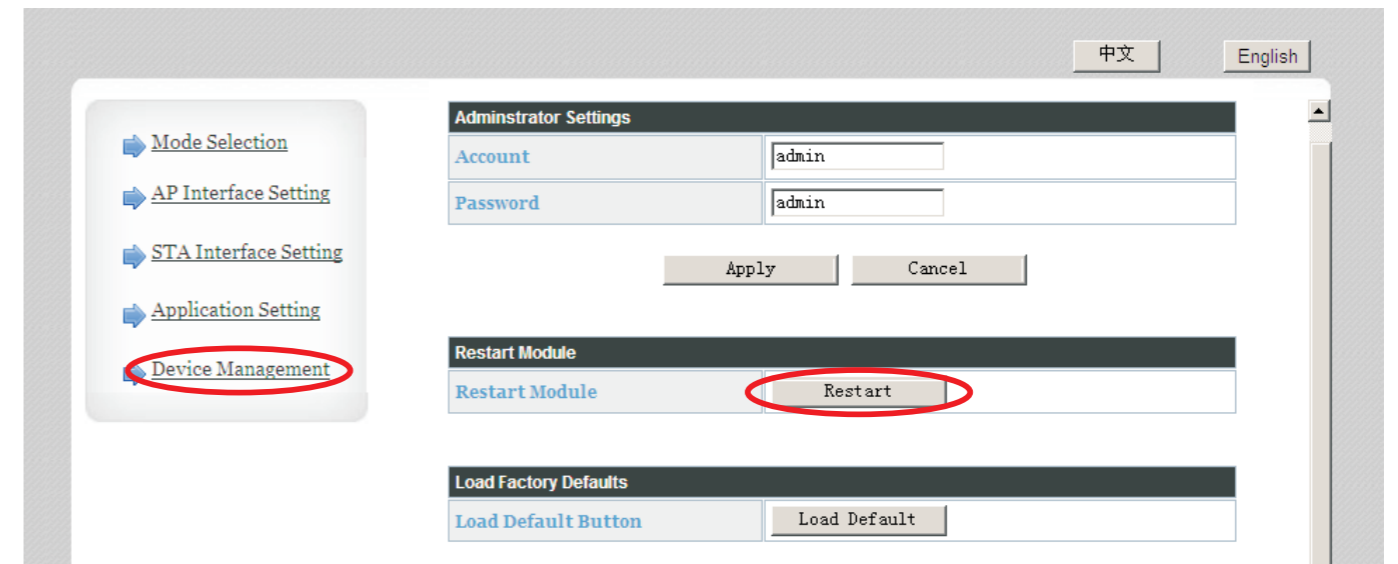

6. Reconnect laptop with local router, register on portal and create your own PV station.